

For each application the appropriate holding magnet

- ⇒ Large stock
- ⇒ Samples for R&D
- ⇒ Custom-made magnets
- ⇒ Production of prototypes
- ⇒ Consulting service

**Technical and economical optimal solutions
are our target!**

Pot magnets NdFeB with bore and counter bore

Selection of our stock items (other specifications upon request)

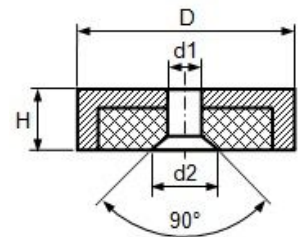

| Item no. | Dimensions in mm | | | | Force |
|----------|------------------|-----|-----|---------|-------|
| | D | d1 | d2 | H | kg |
| 63.2169 | 16±0.2 | 3.4 | 7.5 | 4.5±0.2 | 7 |
| 63.2209 | 20±0.2 | 3.2 | 7.5 | 8±0.2 | 10 |
| 63.2259 | 25±0.2 | 5.5 | 11 | 9±0.2 | 25 |

Characteristic

- Magnet material NdFeB (Neodymium)
- Highest force at minimal size
- Best cost/force ratio
- Coating Nickel
(other coatings upon request)
- Working temperature up to 80°C
(> 80°C upon request)

Air gap / Force comparison

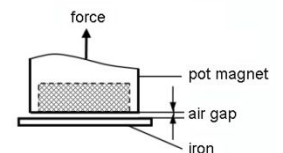
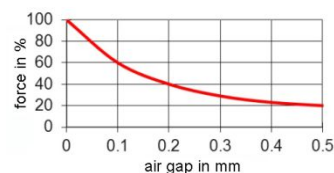

Pot magnets NdFeB with internal thread

Selection of our stock items (other specifications upon request)

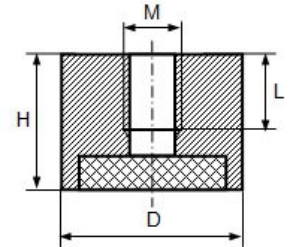

| Item no. | Dimensions in mm | | | | Force |
|----------|------------------|--------|----|----|-------|
| | D | H | M | L | kg |
| 63.2121 | 12±0.2 | 12±0.2 | M4 | 7 | 5 |
| 63.2161 | 16±0.2 | 12±0.2 | M5 | 4 | 10 |
| 63.2201 | 20±0.2 | 16±0.2 | M6 | 10 | 15 |
| 63.2251 | 25±0.2 | 16±0.2 | M6 | 10 | 25 |
| 63.2302 | 32±0.2 | 20±0.2 | M6 | 10 | 40 |

Characteristic

- Magnet material NdFeB (Neodymium)
- Highest force at minimal size
- Best cost/force ratio
- Coating Nickel
(other coatings upon request)
- Working temperature up to 80°C
(> 80°C upon request)

Air gap / Force comparison

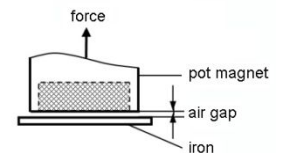
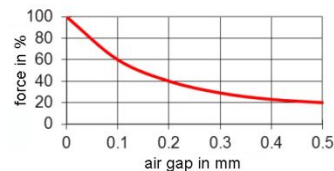

Pot magnets NdFeB with external thread

Selection of our stock items (other specifications upon request)



| Item no. | Dimensions in mm | | | | Force |
|----------|------------------|--------|-------|----|-------|
| | D | H | H1 | M | kg |
| 63.2163 | 16±0.2 | 12±0.2 | 5±0.2 | M4 | 10 |
| 63.2202 | 20±0.2 | 16±0.2 | 6±0.2 | M6 | 15 |
| 63.2203 | 25±0.2 | 17±0.2 | 7±0.2 | M6 | 25 |

Characteristic

- Magnet material NdFeB (Neodymium)
- Highest force at minimal size
- Best cost/force ratio
- Coating Nickel
(other coatings upon request)
- Working temperature up to 80°C
(> 80°C upon request)

Air gap / Force comparison

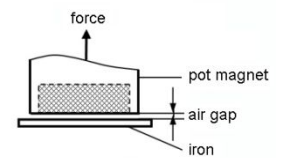
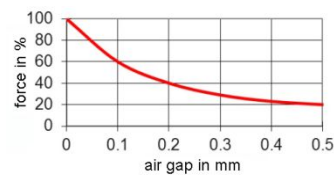

Pot magnets NdFeB with hexagon and external thread

Selection of our stock items (other specifications upon request)



| Item no. | Dimensions in mm | | | | | Force |
|----------|------------------|----|--------|----|----|-------|
| | D | SW | H | H1 | M | kg |
| 63.2191 | 20.5±0.1 | 19 | 16±0.2 | 6 | M6 | 15 |
| 63.2241 | 25.5±0.1 | 24 | 17±0.2 | 7 | M6 | 25 |
| 63.2321 | 34±0.1 | 32 | 18±0.2 | 8 | M6 | 40 |

Characteristic

- Magnet material NdFeB (Neodymium)
- Highest force at minimal size
- Best cost/force ratio
- Coating Nickel
(other coatings upon request)
- Working temperature up to 80°C
(> 80°C upon request)

Air gap / Force comparison

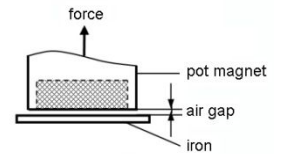
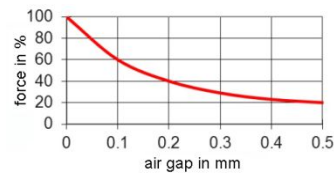

Pot magnets HF without bore and thread

Selection of our stock items (other specifications upon request)

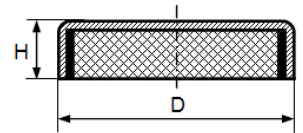

| Item no. | Dimensions in mm | | Force kg |
|----------|------------------|---------------|-------------|
| | D | H | |
| 62.4130 | 13±0.2 | 4.5+0.2/-0.1 | 1.0 |
| 62.4160 | 16±0.2 | 4.5+0.2/-0.1 | 1.8 |
| 62.4200 | 20±0.2 | 6.0+0.2/-0.1 | 3.0 |
| 62.4250 | 25±0.2 | 7.0+0.3/-0.2 | 4.0 |
| 62.4320 | 32±0.3 | 7.0+0.3/-0.2 | 8.0 |
| 62.4400 | 40+0.5/-0.3 | 8.0+0.4/-0.2 | 12.5 |
| 62.4500 | 50+0.5/-0.3 | 10.0+0.5/-0.2 | 22.0 |
| 62.4630 | 63+0.6/-0.3 | 14.0+0.5/-0.2 | 35.0 |
| 62.4800 | 80+0.6/-0.3 | 18.0+0.5/-0.2 | 60.0 |

Characteristic

- Magnet material HF (Hard Ferrite)
- Coating steel housing Zinc (other coatings upon request)
- Working temperature up to 200°C (>200°C upon request)

Air gap / Force comparison

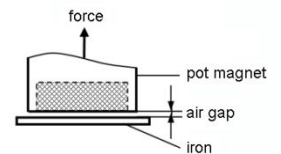
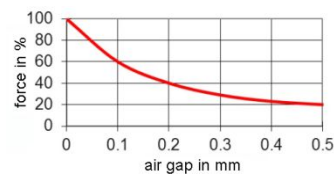

Pot magnets HF with bore and counter bore

Selection of our stock items (other specifications upon request)

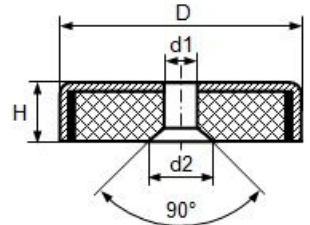

| Item no. | Dimensions in mm | | | | Force |
|----------|------------------|-----|------|--------------|-------|
| | D | d1 | d2 | H | kg |
| 62.6160 | 16±0.2 | 3.3 | 6.5 | 4.5+0.2/-0.1 | 1.4 |
| 62.6200 | 20±0.2 | 4.2 | 9.0 | 6+0.2/-0.1 | 2.7 |
| 62.6250 | 25±0.2 | 5.5 | 10.4 | 7+0.3/-0.2 | 3.6 |
| 62.6320 | 32±0.3 | 5.5 | 10.4 | 7+0.3/-0.2 | 7.2 |
| 62.6400 | 40±0.3 | 5.5 | 10.4 | 8+0.4/-0.2 | 9.0 |

Characteristic

- Magnet material HF (Hard Ferrite)
- Coating steel housing Zinc (other coatings upon request)
- Working temperature up to 200°C (>200°C upon request)

Air gap / Force comparison

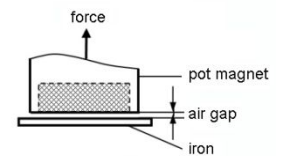
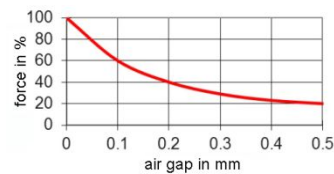

BBA AG

Schachenallee 29 / Postfach
 CH-5001 Aarau
 Tel. +41 62 836 90 40
 Fax +41 62 824 61 40
 www.bba.ch • info@bba.ch



Pot magnets HF with bore

Selection of our stock items (other specifications upon request)

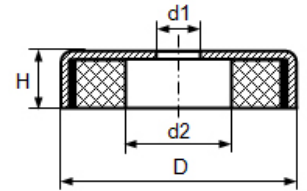

| Item no. | Dimensions in mm | | | | Force |
|----------|------------------|-----|------|-------------|-------|
| | D | d1 | d2 | H | kg |
| 62.6500 | 50+0.5/-0.3 | 8.5 | 22.0 | 10+0.5/-0.2 | 18 |
| 62.6630 | 63+0.6/-0.3 | 6.5 | 24.0 | 14+0.5/-0.2 | 29 |
| 62.6800 | 80+0.6/-0.3 | 6.5 | 11.5 | 18+0.5/-0.2 | 54 |

Characteristic

- Magnet material HF (Hard Ferrite)
- Coating steel housing Zinc (other coatings upon request)
- Working temperature up to 200°C (>200°C upon request)

Air gap / Force comparison

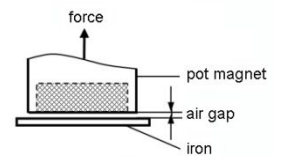
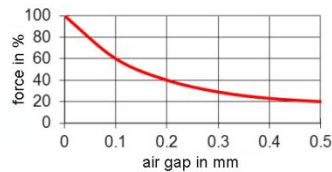

Pot magnets HF with screwed bush

Selection of our stock items (other specifications upon request)

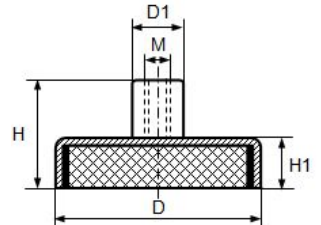

| Item no. | Dimensions in mm | | | | | Force |
|----------|------------------|---------------|---------------|--------|-----|-------|
| | D | H | H1 | D1 | M | kg |
| 62.5130 | 13±0.2 | 11.5+0.2/-0.1 | 4.5+0.2/-0.1 | 6±0.2 | M3 | 1.0 |
| 62.5160 | 16±0.2 | 11.5+0.2/-0.1 | 4.5+0.2/-0.1 | 6±0.2 | M3 | 1.8 |
| 62.5200 | 20±0.2 | 13.0+0.5/-0.3 | 6.0+0.3/-0.2 | 6±0.2 | M3 | 3.0 |
| 62.5250 | 25±0.2 | 15.0+0.6/-0.3 | 7.0+0.3/-0.2 | 8±0.2 | M4 | 4.0 |
| 62.5320 | 32±0.3 | 15.0+0.6/-0.3 | 7.0+0.3/-0.2 | 8±0.2 | M4 | 8.0 |
| 62.5400 | 40+0.5/-0.3 | 18.0+0.6/-0.3 | 8.0+0.3/-0.2 | 10±0.2 | M5 | 12.5 |
| 62.5500 | 50+0.5/-0.3 | 22.0+0.6/-0.3 | 10.0+0.3/-0.2 | 12±0.2 | M6 | 22.0 |
| 62.5630 | 63+0.6/-0.3 | 30.0+0.6/-0.3 | 14.0+0.3/-0.2 | 15±0.2 | M8 | 35.0 |
| 62.5800 | 80+0.6/-0.3 | 34.0+0.6/-0.3 | 18.0+0.3/-0.2 | 20±0.2 | M10 | 60.0 |

Characteristic

- Magnet material HF (Hard Ferrite)
- Coating steel housing Zinc (other coatings upon request)
- Working temperature up to 200°C (>200°C upon request)

Air gap / Force comparison

